

LEGEND	
	Direction of Travel
	Sign
	North Arrow
	Tubular marker
	Certified TCP
	HLWD

Figure # 7.8 in the TCMWR 2015 Edition
 Single Lane Alternating

This Traffic Control Plan is designed to accommodate patch work on Railway Ave. There is one patch at this location
 Work to commence Tuesday, Aug. 14th, 2018 and is expected to be completed in one day, however permit will be requested for a week

Work hours shall be from 7:00 am - 5:00 pm
 All signs and traffic devices shall be placed in compliance with WCB and the TCMWR

 RoF RIGHT ON FLAGGING
 SEWER PAVING
Drawing NTS Drawing No. LP-Railway Ave - 02

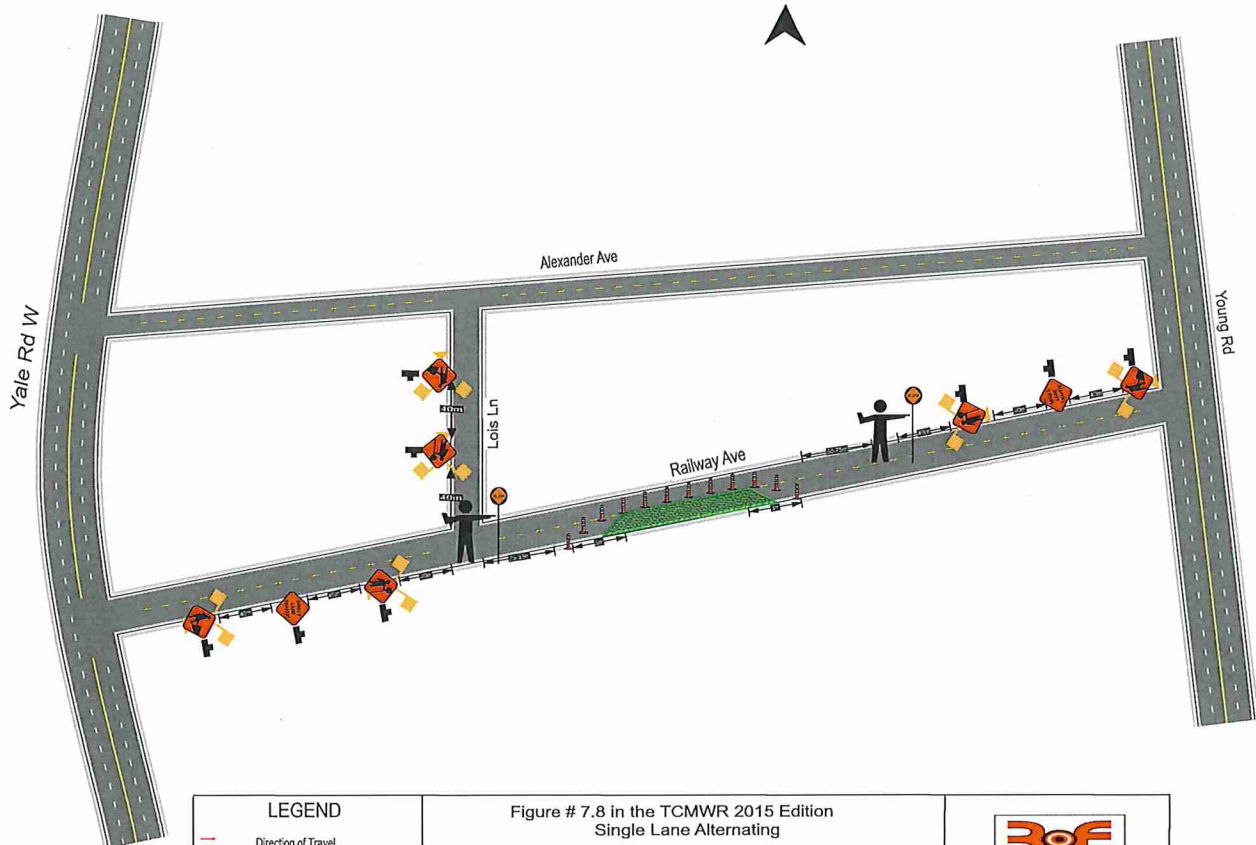

LEGEND	
	Direction of Travel
	Sign
	North Arrow
	Tubular marker
	Certified TCP
	HLWD

Figure # 7.8 in the TCMWR 2015 Edition
Single Lane Alternating

This Traffic Control Plan is designed to accommodate patch work on Railway Ave. There is one patch at this location

Work to commence Tuesday, Aug. 14th, 2018 and is expected to be completed in one day, however permit will be requested for a week

Work hours shall be from 7:00 am - 5:00 pm

All signs and traffic devices shall be placed in compliance with WCB and the TCMWR



RIGHT ON FLAGGER
EST. 2012



INVARION

Drawing NTS Drawing No. LP-Railway Ave - 01